

Extendable Fender

Instruction Manual

RF001

Please read all instructions before installing your new fender.

Warning

Failure to install fenders properly may result in damage to your bicycle, serious injury, and/or death.

Bridge Mount

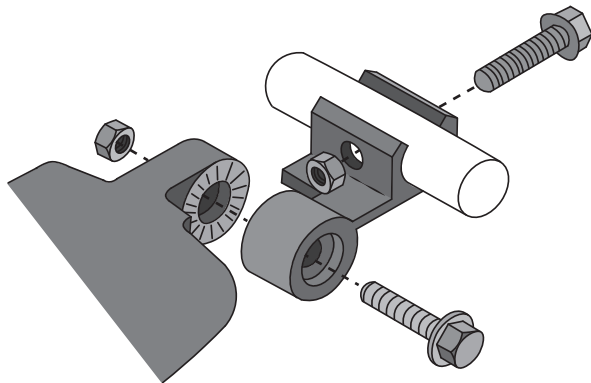

Seatpost Mount

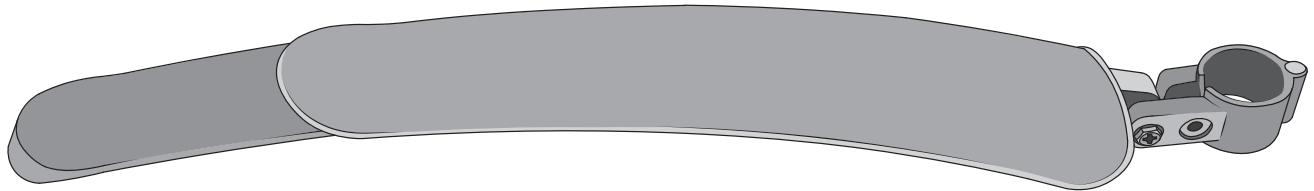
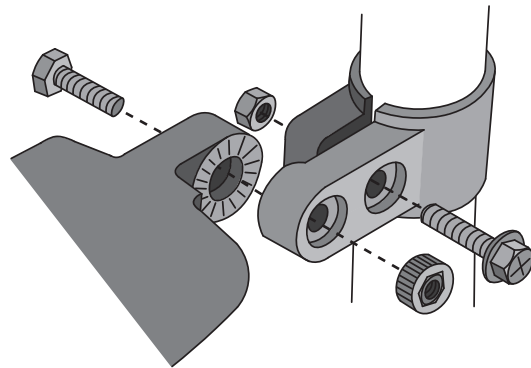

Installation

1. Pick the appropriate mount based on the style of your frame and follow the directions below.

Bridge Mount:

2. Install by snapping bridge clip onto the seat stay bridge as shown.
3. Align bolt holes in the mount with the hole in the bridge. Bolt in place.
4. Attach fender to mount and secure with nut and bolt as shown. Align the fender with the tire and tighten mounting bolt once desired alignment is achieved.

Seatpost Mount:

2. Install the clamp to the seatpost at the desired height. Do not fully tighten.
3. Attach fender to mount using the supplied bolt and no-turn nut as shown. Do not fully tighten.
4. Adjust fender so that there is ample clearance between the fender and tire.
5. Once the desired angle is achieved tighten the mount and fender bolt.

Note: To extend, firmly grip the fender body and pull straight back on the lower rear portion of the fender.

SUNLITE